

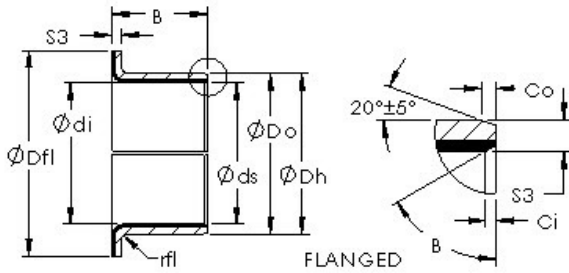

BEARING PRECISION AXLE CORP.



AST AST40 F25215 plain bearings

Bearing No. AST40 F25215

Bore Diameter	25 mm
Outer Diameter	28 mm
Bearing Type	flanged
Shaft Dia., Nominal (d)	25.0000
Shaft Size (ds) - 25 -0.02 / -0.041	25 0.02 / 0.041
Housing Bore Dia. (Dh)	28 +0.021 / +0
Bearing Outside Diameter, Nominal(Do)	28.000
Bearing Outside Diameter Tolerance (Do tol.)	28.075 / 28.035
Bearing Bore after Mounting (di)	25.071 / 24.99
Average Clearance (Cd)	0.0610
Wall Thickness (S3)	1.505
Bearing Length, Nominal (B)	21.500
Bearing Length Tolerance (B tol.) - +0.25 / -0.25	+0.25 / 0.25
OD Chamfer Length (Co)	0.700
ID Chamfer Angle (B deg.)	30
ID Chamfer Length (Ci)	0.500
Flange Dia. (Dfl pm 0.5)	35.000
Flange Radius (rfl)	1.500
Material	Steel shell with PTFE / Polymer Fiber lining

AST40 F25215 Bearing 2D drawings and 3D CAD models