

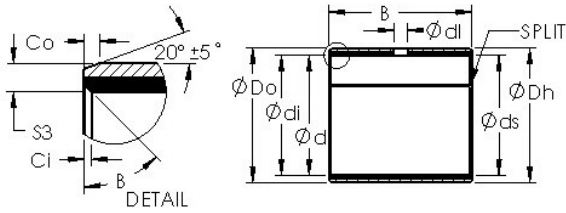

BEARING PRECISION AXLE CORP.



AST AST50 07IB12 plain bearings

Bearing No. AST50 07IB12

Bore Diameter	11,1125 mm
Bearing Type	straight
Shaft Dia., Nominal (d)	0.4375
Shaft Size (ds) - 0.4365	0.4355
Housing Bore Dia. (Dh) - 0.5316	0.5309
Bearing Bore after Mounting (di) - 0.4394	0.4367
Average Clearance (Cd)	0.0021
Wall Thickness (S3)	0.047
Bearing Length, Nominal (B)	0.875
Bearing Length Tolerance (B tol.) - +.010 / -0.010	+.010 / 0.010
OD Chamfer Length (Co)	0.023
ID Chamfer Angle (B deg.)	30
ID Chamfer Length (Ci)	0.014
Material	Carbon steel shell with PTFE / Fiber lining

AST50 07IB12 Bearing 2D drawings and 3D CAD models