

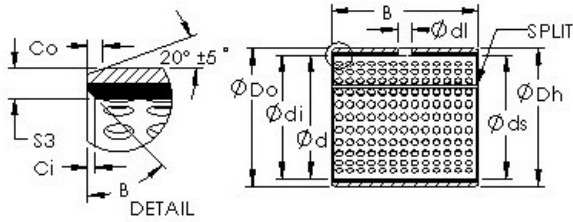

BEARING PRECISION AXLE CORP.



AST AST20 10IB10 plain bearings

Bearing No. AST20 10IB10

Bore Diameter	15,875 mm
Outer Diameter	18,2626 mm
Bearing Type	straight
Shaft Dia., Nominal (d)	0.6250
Shaft Size (ds)	0.6146 / 0.6136
Housing Bore Dia. (Dh)	0.7195 / 0.7178
Bearing Outside Diameter, Nominal(Do)	0.719
Bearing Bore after Mounting (di)	0.6195 / 0.6167
Average Clearance (Cd)	0.0040
Wall Thickness (S3)	0.051
Bearing Length, Nominal (B)	0.625
Bearing Length Tolerance (B tol.) - +.010 / -0.010	+0.010 / 0.010
OD Chamfer Length (Co)	0.024
ID Chamfer Angle (B deg.)	30
ID Chamfer Length (Ci)	0.012
Lube Hole Dia. (dl)	0.156
Material	Carbon steel shell with POM plastic liner

AST20 10IB10 Bearing 2D drawings and 3D CAD models