

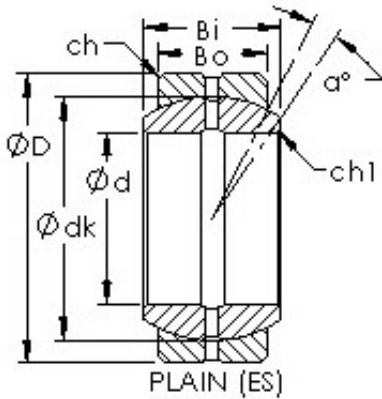

# BEARING PRECISION AXLE CORP.



## AST GEZ88ES plain bearings

Bearing No. GEZ88ES

Bore Diameter	88,9 mm
Outer Diameter	139,7 mm
Bearing Type	plain
Bore Dia (d)	3.5000
Outer Dia (D)	5.5000
Outer Width (Bo)	2.6250
Inner Width (Bi)	3.0620
Dynamic Load Rating (Cr)	152,861
Static Load Rating (Cor)	458,582
Max. shaft corner radius, or 45 deg. chamfer (ch1)	0.040
Max. housing corner radius, or 45 deg. chamfer (ch)	0.040
Spherical Diameter (dk or Dk)	5.039
Mis-alignment Angle (a deg.)	6
Weight (g)	4,800.00
Material	52100 Chrome steel, or equivalent

GEZ88ES Bearing 2D drawings and 3D CAD models