

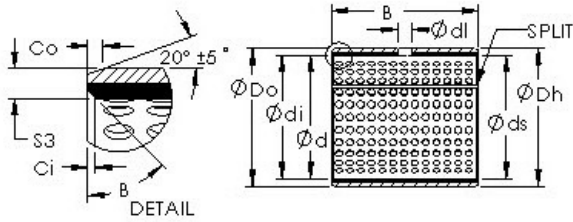

BEARING PRECISION AXLE CORP.



AST AST20 361B32 plain bearings

Bearing No. AST20 361B32

Bore Diameter	57,15 mm
Outer Diameter	61,9252 mm
Bearing Type	straight
Shaft Dia., Nominal (d)	2.2500
Shaft Size (ds)	2.2378 / 2.2360
Housing Bore Dia. (Dh)	2.4387 / 2.4375
Bearing Outside Diameter, Nominal(Do)	2.438
Bearing Bore after Mounting (di)	2.2463 / 2.2415
Average Clearance (Cd)	0.0070
Wall Thickness (S3)	0.098
Bearing Length, Nominal (B)	2.000
Bearing Length Tolerance (B tol.) - +.010 / -0.010	+0.010 / 0.010
OD Chamfer Length (Co)	0.070
ID Chamfer Angle (B deg.)	45
ID Chamfer Length (Ci)	0.031
Lube Hole Dia. (dl)	0.313
Material	Carbon steel shell with POM plastic liner

AST20 361B32 Bearing 2D drawings and 3D CAD models