

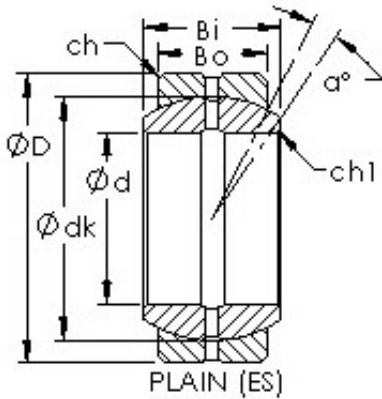

BEARING PRECISION AXLE CORP.



AST GEG25ES plain bearings

Bearing No. GEG25ES

Bore Diameter	25 mm
Outer Diameter	47 mm
Bearing Type	plain
Bore Dia (d)	25.0000
Outer Dia (D)	47.0000
Outer Width (Bo)	18.0000
Inner Width (Bi)	28.0000
Dynamic Load Rating (Cr)	62,000
Static Load Rating (Cor)	310,000
Max. shaft corner radius, or 45 deg. chamfer (ch1)	0.600
Max. housing corner radius, or 45 deg. chamfer (ch)	0.600
Spherical Diameter (dk or Dk)	40.700
Mis-alignment Angle (a deg.)	17
Weight (g)	199.00
Material	52100 Chrome steel, or equivalent

GEG25ES Bearing 2D drawings and 3D CAD models