

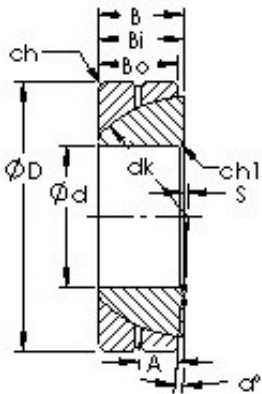

BEARING PRECISION AXLE CORP.



GAC130S Bearing 2D drawings and 3D CAD models

AST GAC130S plain bearings

Bearing No. GAC130S

Size	130x200x45 mm
Bore Diameter	130 mm
Outer Diameter	200 mm
Width	45 mm
Bearing Type - steel-on-steel	steelonsteel
Bore Dia (d)	130.0000
Outer Dia (D)	200.0000
Width (B)	45.0000
Outer Width (Bo)	43.0000
Inner Width (Bi)	45.0000
Dynamic Load Rating (Cr)	710,000
Static Load Rating (Cor)	3,550,000
Max. shaft corner radius, or 45 deg. chamfer (ch1)	2.500
Max. housing corner radius, or 45 deg. chamfer (ch)	2.500
Spherical Diameter (dk or Dk)	188.000
Mis-alignment Angle (a deg.)	1
Lubrication Groove Location (A)	19.000
Spherical Center Location (S)	18
Weight (g)	5,920.00
Material	52100 Chrome steel, or equivalent