

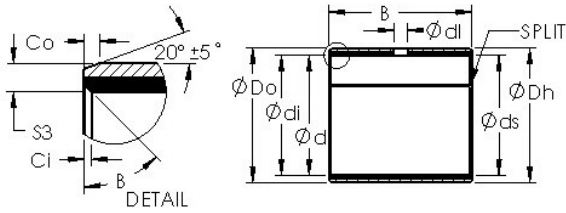

BEARING PRECISION AXLE CORP.



AST AST50 108IB56 plain bearings

Bearing No. AST50 108IB56

| | |
|--|---|
| Bore Diameter | 171,45 mm |
| Bearing Type | straight |
| Shaft Dia., Nominal (d) | 6.7500 |
| Shaft Size (ds) - 6.75 | 6.7475 |
| Housing Bore Dia. (Dh) - 6.9374 | 6.9358 |
| Bearing Bore after Mounting (di) - 6.757 | 6.7502 |
| Average Clearance (Cd) | 0.0048 |
| Wall Thickness (S3) | 0.095 |
| Bearing Length, Nominal (B) | 3.500 |
| Bearing Length Tolerance (B tol.) - +.010 / -0.010 | +.010 / 0.010 |
| OD Chamfer Length (Co) | 0.072 |
| ID Chamfer Angle (B deg.) | 30 |
| ID Chamfer Length (Ci) | 0.031 |
| Material | Carbon steel shell with PTFE / Fiber lining |

AST50 108IB56 Bearing 2D drawings and 3D CAD models