

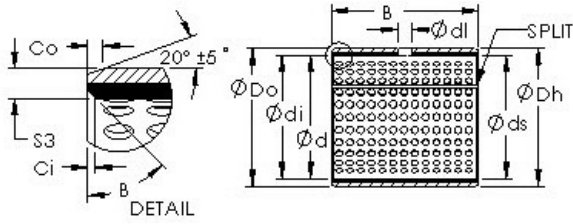

# BEARING PRECISION AXLE CORP.



## AST AST20 16050 plain bearings

Bearing No. AST20 16050

Bore Diameter	160 mm
Outer Diameter	165 mm
Bearing Type	straight
Shaft Dia., Nominal (d)	160.0000
Shaft Size (ds) - 160 +0 / -0.063	160 +0 / 0.063
Housing Bore Dia. (Dh) - 165 +0.040 / -0	165 +0.040 / 0
Bearing Outside Diameter, Nominal(Do)	165.000
Bearing Outside Diameter Tolerance (Do tol.)	165.170 / 165.100
Bearing Bore after Mounting (di)	160.270 / 160.110
Average Clearance (Cd)	0.2170
Wall Thickness (S3)	2.418
Bearing Length, Nominal (B)	50.000
Bearing Length Tolerance (B tol.) - +0 / -0.40	+0 / 0.40
OD Chamfer Length (Co)	1.800
ID Chamfer Angle (B deg.)	45
ID Chamfer Length (Ci)	0.800
Lube Hole Dia. (dl)	9.500
Material	Carbon steel shell with POM plastic liner

AST20 16050 Bearing 2D drawings and 3D CAD models