

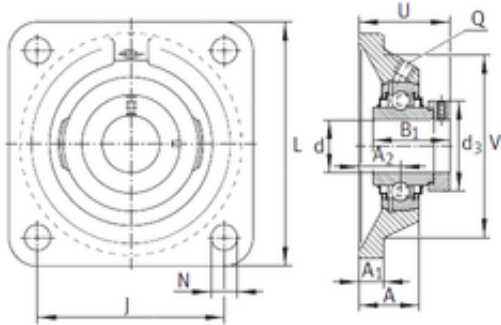

# BEARING PRECISION AXLE CORP.

## INA RCJO60 bearing units



RCJO60 Bearing 2D drawings and 3D CAD models

Bearing No. RCJO60

Bore Diameter	60 mm
d	60 mm
V	170 mm
U	78,4 mm
Thread (Q)	Rp1/8
d3	89 mm
A	49,5 mm
A1	22 mm
B1	68,4 mm
J	150 mm
L	195 mm
N	23 mm
A2	33 mm
Weight	6,8 Kg
Basic dynamic load rating (C)	82 kN
Category	Flange Block Bearings
Inventory	0.0
Manufacturer Name	SCHAEFFLER GROUP
Minimum Buy Quantity	N/A
Weight / Kilogram	8.143
Product Group	M06110
Number of Mounting Holes	4
Mounting Method	Eccentric Collar
Housing Style	4 Bolt Square Flange Block
Rolling Element	Ball Bearing
Housing Material	Cast Iron



## BEARING PRECISION AXLE CORP.

Expansion / Non-expansion	Non-expansion
Mounting Bolts	23 Millimeter
Relubricatable	Yes
Insert Part Number	GNE60KRRB
Seals	Double Land Riding Rubber Contact
Housing Configuration	1 Piece Solid
Pilot Configuration	No Pilot
Inch - Metric	Metric
Long Description	4 Bolt Square Flange Block; 60MM Bore; 212.1MM Bolt Circle; 150MM Bolt Spacing; 1 Piece Solid; Eccentric Collar Mount; Cast Iron; Ball Bearing; 68.4MM Length Thru Bore; Relubricatable; Double Land Rid
Other Features	Single Row   Extended Inner Race   With Set Screw
Category	Flange Block
UNSPSC	31171501
Harmonized Tariff Code	8483.20.40.40
Noun	Bearing
Keyword String	Flanged
Manufacturer URL	<a href="http://www.ina.com">http://www.ina.com</a>
Manufacturer Item Number	RCJO60
Weight / LBS	14.99
Length Thru Bore	2.693 Inch   68.4 Millimeter
Cartridge Pilot Diameter	0 Inch   0 Millimeter
Bolt Spacing	5.906 Inch   150 Millimeter
Bore	2.362 Inch   60 Millimeter
Cartridge Pilot Depth	0 Inch   0 Millimeter
Nominal Bolt Circle Diameter Round	8.4 Inch   212.1 Millimeter