

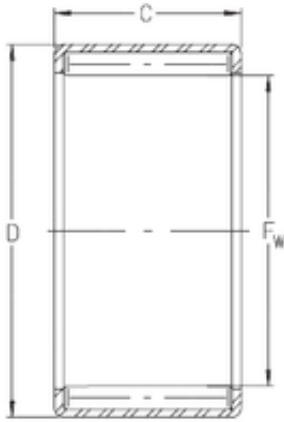

BEARING PRECISION AXLE CORP.

INA SN810 needle roller bearings

Bearing No. SN810



Size	12.7x17.462x15.875 mm
Bore Diameter	12,7 mm
Outer Diameter	17,462 mm
Width	15,875 mm
Fw	12,7 mm
D	17,462 mm
C	15,875 mm
Weight	0,011 Kg
Basic dynamic load rating (C)	12,9 kN
Basic static load rating (C0)	23,6 kN

SN810 Bearing 2D drawings and 3D CAD models